

**LEGEND:**

- PIN FOUND
- PIN SET
- UTILITY POLE
- PERCOLATION TEST
- DEEP HOLE TEST
- HYDRANT

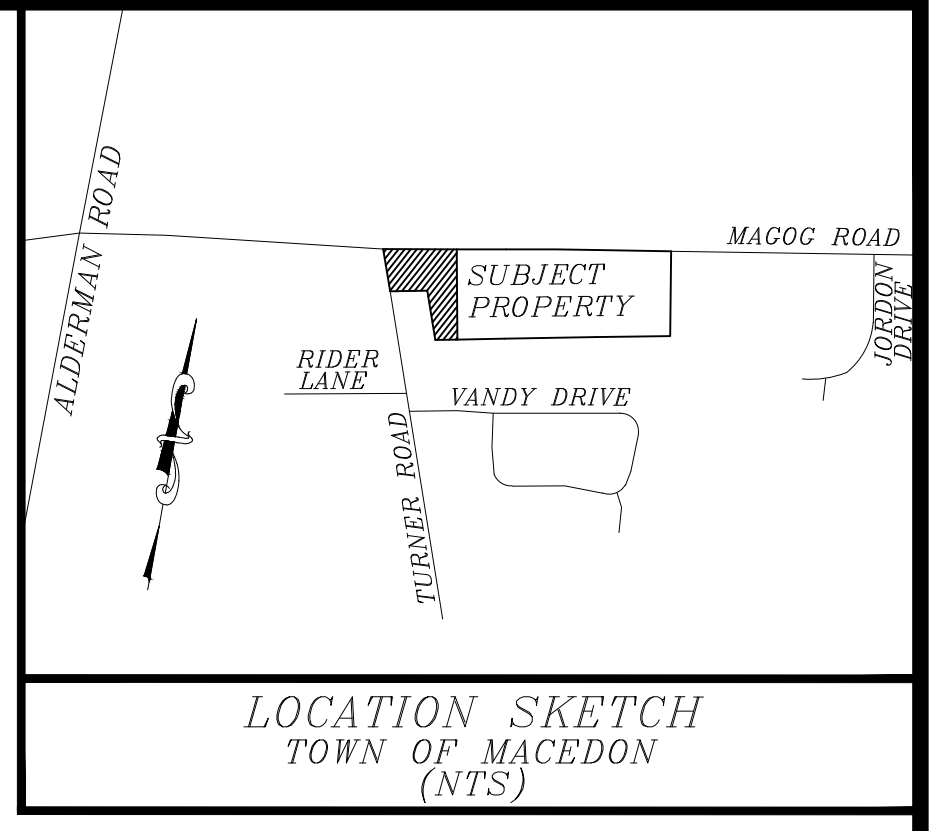

**LOT 2**  
**AREA=**  
 154996 SQ. FT.  
 3.558 ACRES  
**TO CENTERLINE**  
**AREA=**  
 138191 SQ. FT.  
 3.172 ACRES  
**TO ROAD LINE**

**SCHEDULE OF ELEVATIONS:**

LOCATION:	ELEVATION:
FINISHED FLOOR	525.0
HOUSE INVERT	513.0
SEPTIC TANK OUTLET	512.9
DISTRIBUTION BOX INLET	511.7
LINE#	HIGH END INVERT
1	511.4
2	511.0
3	510.6
4	510.2
	FUTURE EXPANSION AREA

**WCWSA STANDARD NOTES:**

1. WATER SERVICE INSTALLATIONS SHALL BE MADE IN ACCORDANCE WITH WAYNE COUNTY WATER AND SEWER AUTHORITY RULES, REGULATIONS AND PROCEDURES GOVERNING SERVICE LINE AND METER INSTALLATIONS.
2. WATER SERVICE SHALL NOT BE INSTALLED WITHIN TEN (10) FEET OF ANY PORTION OF A LEACH SYSTEM OR ANY RELATED APPURTENANCES.
3. MINIMUM ALLOWABLE WATER SERVICE PIPE DIAMETER IS ONE (1) INCH.
4. WATER SERVICE MATERIALS MAY CONSIST OF:
  - A. HIGH DENSITY POLYETHYLENE TUBING CLASSIFIED AS PE 3808 OR PE 3408 WITH 200 PSI PRESSURE RATING AND YIELDING THE SAME OUTER DIAMETER (OD) AS COPPER TUBING OR BE STAMPED CTS (COPPER TUBE SIZE)
  - B. TYPE K COPPER TUBING.
  - C. ONLY COMPRESSION FITTINGS PERMISSIBLE WITH COPPER TUBING.
  - D. ONLY COMPRESSION FITTINGS PERMISSIBLE WITH STAINLESS STEEL INSERTS FOR POLYETHYLENE TUBING.
5. WATER SERVICES SHALL BE INSTALLED WITH A MINIMUM OF FOUR AND ONE HALF (4½) FEET OF COVER.
6. NOTIFY DIG SAFELY NEW YORK A MINIMUM OF TWO (2) BUSINESS DAYS IN ADVANCE OF DIGGING BY CALLING 1-800-962-7962.

**PLAN NOTES:**

- A. THE WASTEWATER TREATMENT SYSTEM SHALL BE INSTALLED IN BASIC CONFORMANCE WITH THE NYSDOH HANDBOOK FOR INDIVIDUAL HOUSEHOLD SYSTEMS ADOPTED 2012, THE APPROVED PLAN DETAILS, AND THE TOWN DEVELOPMENT REGULATIONS.
- B. THE FOLLOWING MINIMUM DISTANCE APPLY TO THIS PROJECT:
  1. BUILDING TO SEPTIC TANK - 10'
  2. BUILDING TO DISTRIBUTION LINE - 20'
  3. DISTRIBUTION LINE TO PROPERTY LINE - 10'
  4. WASTERSERVICE TO DISTRIBUTION LINE - 10'
  5. WASTERSERVICE TO SEPTIC TANK - 100' MINIMUM (NOT INCLUDED)
  6. DISTRIBUTION LINE TO EDGE OF DRIVEWAY - 10'

**SOIL TEST DATA:**

PERCOLATION TESTS WERE COMPLETED ON MARCH 9, 2020 AND THE DEEP HOLE EXCAVATION WAS COMPLETED ON MARCH 12, 2020. THESE TESTS WERE CONDUCTED BY GREENE LAND SURVEYING, PLLC.

**PERCOLATION TESTS:**

TEST	DEPTH (IN.)	TIME (MIN)
E	24	1,1,1
F	20	1,2,2

**DEEP HOLE EXCAVATION:**  
 SOIL STRATA: 0-12" TOPSOIL, 12-60" SAND, ROOTS TO 36" NO MINERAL DEPOSITS, BED ROCK, OR WATER NOTED.

**WAYNE COUNTY SOIL SURVEY**  
 Plate #58.  
 H1a - HILTON GRAVELLY LOAM, 0-3% SLOPES  
 O1b - ONTARIO GRAVELLY LOAM, 3-8% SLOPES

**WASTEWATER TREATMENT SYSTEM DESIGN DATA:**  
 PERCOLATION RATES IN THE AREA OF THE PROPOSED WASTEWATER TREATMENT SYSTEM WERE 1-2 MINUTES ON THE DATE THE TESTS WERE CONDUCTED. THE SYSTEM IS DESIGNED FOR A MINIMUM PERCOLATION RATE OF 11-15 MINUTES. THE OWNER IS PROPOSING A THREE BEDROOM HOME WITH A FLOW RATE EQUAL TO 350 GALLONS PER DAY, WHICH REQUIRES 202 LINEAL FEET OF DISTRIBUTION LINE WITH A 2'-0" WIDE TRENCH. THE SITE DESIGN SHOWN PROVIDES FOR 4 DISTRIBUTION LINES AT 60' EACH FOR A TOTAL LENGTH OF 240 LINEAL FEET INSTALLED 6" ON CENTER. THE SITE DESIGN INCLUDES A 50% EXPANSION AREA FOR ADDITIONAL LINES IF NECESSARY.

IF WATER SOFTENING EQUIPMENT IS USED IT SHOULD NOT DISCHARGE DIRECTLY TO A CONCRETE SEPTIC TANK.

**NOTES:**

1. THE TOP OF THE DISTRIBUTION BOX SHALL NOT BE MORE THAN 12" BELOW FINISHED GRADE.
2. THERE SHALL BE A MINIMUM 2" CLEARANCE BETWEEN THE OVERSIS AND THE BOTTOM OF THE BOX.
3. ALL ACTIVE OUTLETS TO HAVE ADJUSTABLE FLOW REGULATORS INSTALLED.
4. BAFFLES ARE NOT REQUIRED UNLESS THE INLET PIPE EXCEEDS A SLOPE GREATER THAN 1/2" / FT. (4%)
5. THE DISTRIBUTION BOX SHALL BE INSTALLED LEVEL ON A STABLE BASE.
6. IF A BAFFLE IS INSTALLED, NO OUTLET SHALL BE USED WHICH IS AHEAD OF THE BAFFLE.

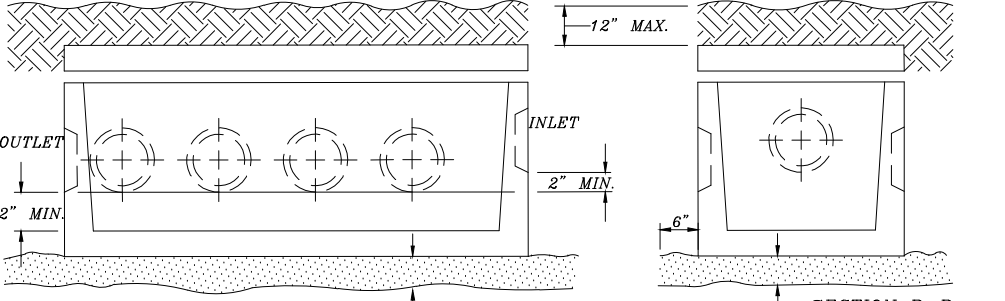
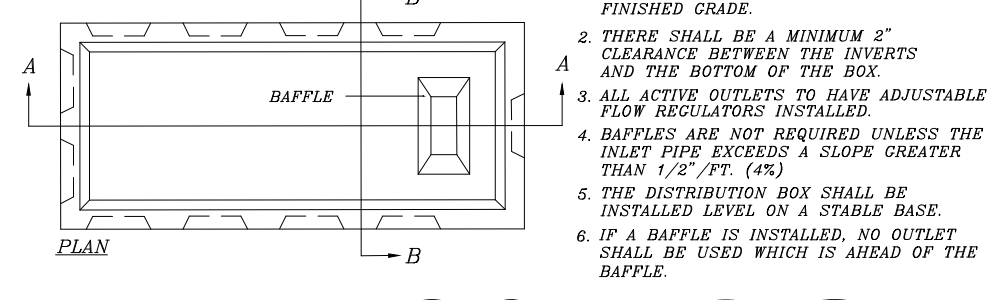

**TYPICAL DISTRIBUTION BOX (N.T.S.)**

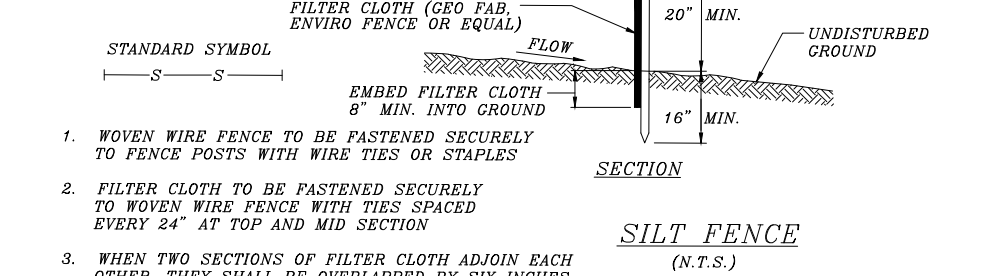
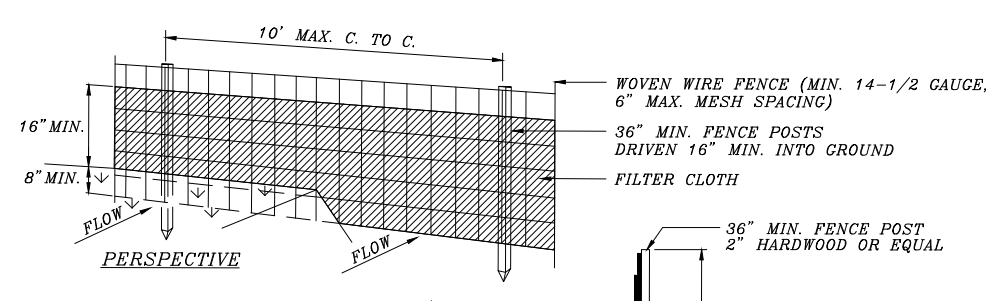

**SILT FENCE (N.T.S.)**

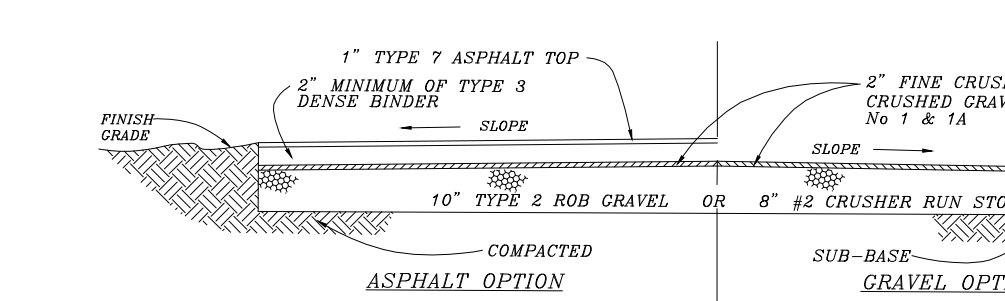

**TYPICAL DRIVEWAY SECTION (N.T.S.)**

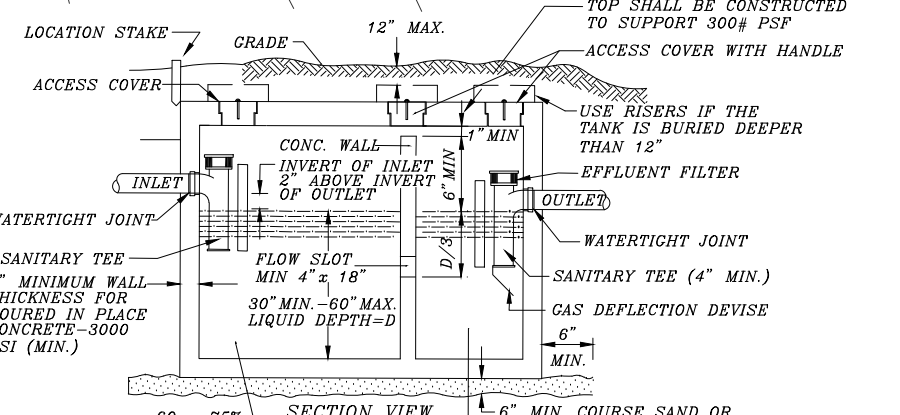

**TYPICAL DUAL COMPARTMENT CONCRETE SEPTIC TANK (N.T.S.)**

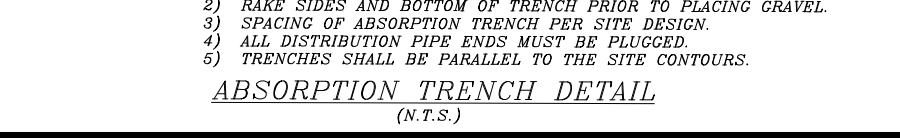
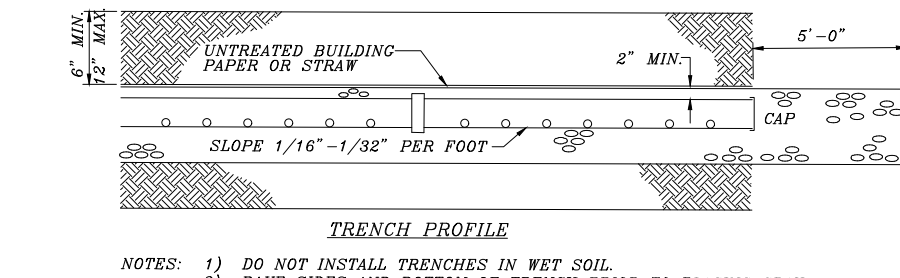
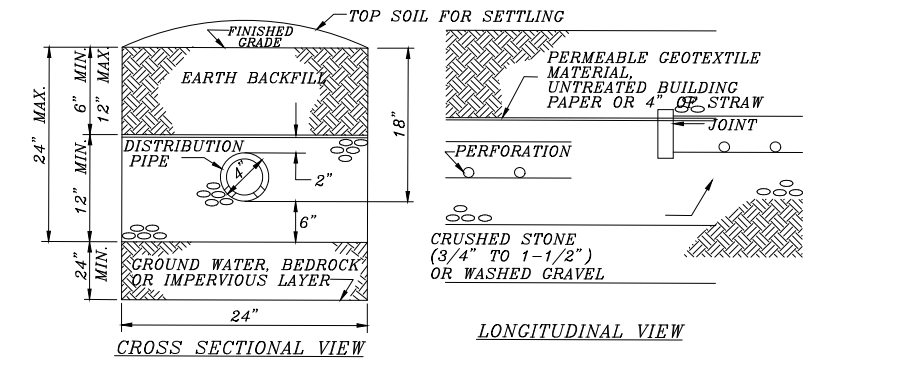
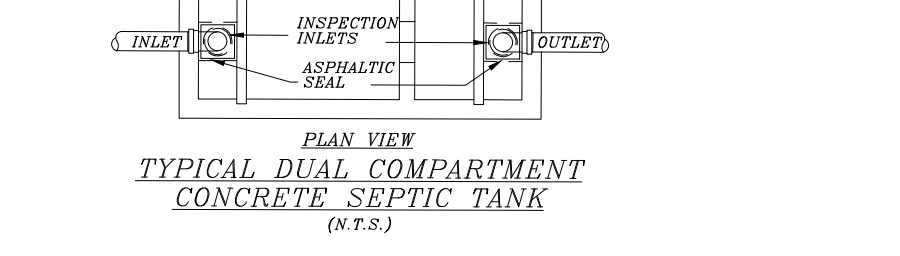

**ABSORPTION TRENCH DETAIL (N.T.S.)**

- NOTES:**
- 1) DO NOT INSTALL TRENCHES IN WET SOIL.
  - 2) BASE SIZE AND METHOD OF TRENCH PRIOR TO PLACING GRAVEL.
  - 3) SPACING OF ABSORPTION TRENCH PER SITE DESIGN.
  - 4) ALL DISTRIBUTION PIPE ENDS MUST BE PLUGGED.
  - 5) TRENCHES SHALL BE PARALLEL TO THE SITE CONTOURS.

- SPECIFICATIONS LEGEND:**
1. BUILDING TO SEPTIC TANK - 4" PVC ASTM-3034, SDR 21 OR SCHEDULE 40. PIPE SHALL BE INSTALLED AT A MINIMUM SLOPE OF 1/4" PER FOOT ON A COMPACTED SUB-BASE WITH A MINIMUM 4" CRUSHED STONE OR SAND ENCASUREMENT. THERE SHALL BE NO BENDS IN THE PIPE BETWEEN THE BUILDING AND THE SEPTIC TANK WITHOUT A CLEAN OUT.
  2. LAUNDRY FACILITIES WASTE SHALL DISCHARGE TO THE SEPTIC TANK. IF A FORCED SYSTEM IS USED, THE DISCHARGE SYSTEM SHALL INCLUDE A CHECK VALVE.
  3. SEPTIC TANK SHALL COMPLY WITH SECTION 75-A OF THE CURRENT NYSDOH REGULATIONS. TANK SHALL BE DUAL COMPARTMENT WITH A CAPACITY OF 1250 GALLONS AND A MINIMUM LIQUID SURFACE AREA OF 34 SQ. FT. FOR THE BUILDING. THE SEPTIC TANK IS SIZED FOR A GARAGE GRINDER. HOWEVER, ONE IS NOT RECOMMENDED. THE SEPTIC TANK IS NOT SIZED FOR A JACUZZI STYLE TUB. AN EFFLUENT FILTER SHALL BE PLACED AT THE SANITARY TEE AT THE TANK OUTLET.
  4. THE PIPE FROM THE SEPTIC TANK TO THE DISTRIBUTION BOX SHALL BE THE SAME AS SPECIFICATION #1 INSTALLED AT A MINIMUM SLOPE OF 1/8" PER FOOT. ALL PIPES IN THE SYSTEM SHALL BE PROPERLY ENCASED IN SAND BEFORE BACKFILLING.
  5. DISTRIBUTION BOX SHALL COMPLY WITH SECTION 75-A OF THE NYSDOH REGULATIONS. IT SHALL BE INSTALLED ON 12" REINFORCED COURSE OR CRUSHED STONE.
  6. PERFORATED PIPE DISTRIBUTION LINES SHALL BE 4" PVC PER ASTM-D2729 INSTALLED AT A SLOPE OF 1/16" TO 1/32" PER FOOT INSTALLED PER PLAN DETAIL. IF CHAMBER INFILTRATORS ARE USED, THEY SHALL BE INSTALLED WITH A MAXIMUM COVER OF 8"
  7. THE SURFACE STORMWATER SYSTEMS SHALL DISCHARGE WATER AWAY FROM THE WASTEWATER TREATMENT SYSTEM AND TO THE LOW SIDE OF THE AREA TO BE DEVELOPED. STORMWATER DISCHARGES SHALL NOT BE CONNECTED TO THE TREATMENT SYSTEM. ROOF DROPS SHALL DISCHARGE TO SPLASH BLOCKS.
  8. WATER SERVICE FROM THE MAIN TO THE ROW SHALL BE A MINIMUM SIZE OF 1" POLYETHYLENE TUBING PE4710 (CTS), ASTM-D3737. SERVICE TO THE HOME CAN BE A MINIMUM OF 1.5" POLYETHYLENE TUBING PE4710 (CTS), ASTM-D3737 PER PLAN NOTES. SERVICE INSTALLATIONS SHALL BE MADE IN ACCORDANCE WITH THE WAYNE COUNTY WATER & SEWER AUTHORITY REGULATIONS AND ANY PERMIT CONDITIONS ESTABLISHED. WATER SERVICES SHALL INCLUDE A METER, PRESSURE REGULATOR AND A CHECK VALVE IN THE HOME.
  9. WATER SAVING DEVICES PER CURRENT NYS BUILDING CODE SHALL BE INSTALLED ON ALL FIXTURE UNITS DISCHARGING WASTEWATER TO THE TREATMENT SYSTEM.

**NOI NOTICE:**  
 THE OPERATOR OF THE CONSTRUCTION ACTIVITY COULD BE SUBJECT TO THE PHASE II REGULATIONS UNDER THE SPEEDS GENERAL PERMIT FOR STORMWATER DISCHARGES FROM CONSTRUCTION ACTIVITY (GP-3-15-002). IF ESTABLISHED THRESHOLDS ARE EXCEEDED, THE OPERATOR MUST FILE A COMPLETED NOTICE OF INTENT (NOI) WITH THE NEW YORK STATE DEPARTMENT OF CONSERVATION (NYSDEC) BEFORE CONSTRUCTION BEGINS. THE SITE DEVELOPER SHOULD MAINTAIN THE FOLLOWING CONSTRUCTION SEQUENCE:

- GENERAL CONSTRUCTION SEQUENCE:**
1. INSTALL TEMPORARY PERIMETER EROSION CONTROL STRUCTURES.
  2. STRIP TOPSOIL, STOCKPILE, AND SEED IF MATERIAL IS TO REMAIN FOR MORE THAN SEVEN (7) DAYS BEFORE IT IS FINAL GRADED, WITH PROTECTION PROVIDED (SILT FENCE).
  3. GRADE SITE AND INSTALL ADDITIONAL INTERIOR EROSION CONTROL STRUCTURES.
  4. INSTALL SITE IMPROVEMENTS.
  5. SEED ALL DISTURBED AREAS WITHIN SEVEN (7) DAYS.
  6. LEAVE ALL EROSION CONTROL MEASURES UNTIL REMOVAL IS APPROVED BY TOWN.

**ACCESS SIGHT DISTANCE:**  
 THE MINIMUM SAFE STOPPING DISTANCE RECOMMENDED AT THE PROPOSED DRIVEWAY ENTRANCE PER AASHTO WITH A SPEED LIMIT OF 55MPH IS - 450 FEET. THE SIGHT DISTANCES LISTED WERE FIELD MEASURED AS FOLLOWS:  
 NORTH = 200± FEET (TO CENTERLINE OF MAGOG ROAD)  
 SOUTH = 350± FEET  
 THE DRIVEWAY FOR A MINIMUM DISTANCE OF 35 FEET OFF THE EDGE OF THE PAYMENT SHALL BE AT A MAXIMUM GRADE OF 3%. THEREAFTER THE DRIVEWAY GRADE SHALL NOT EXCEED 10%.

**SITE DATA:**

**OWNER:** CARL A & LISA K. NORSEN  
 6322 MAGOG ROAD  
 MACEDON, NEW YORK 14522

**PROPERTY:** 2322 MAGOG ROAD  
 TAX ID No. 63111-00-728055  
 TOTAL AREA = 5.558 ACRES

**ZONING: AR-40**

LIMITATIONS	REQUIRED
AREA	40,000 SF
LOT WIDTH	150 FT
SETBACKS	
FRONT	60 FT
REAR	40 FT
SIDE	25 FT

**APPROVALS:**

**PLANNING BOARD CHAIRPERSON:** \_\_\_\_\_ **DATE:** \_\_\_\_\_

**TOWN ENGINEER:** \_\_\_\_\_ **DATE:** \_\_\_\_\_

**HIGHWAY SUPERINTENDENT:** \_\_\_\_\_ **DATE:** \_\_\_\_\_

**PROJECT NOTES:**

- A. ELEVATIONS SHOWN HEREON ARE APPROXIMATELY REFERENCED TO USC & GS QUADRANGLE MAPPING/ NAVD 88.
- B. THE LOT DEVELOPMENT DESIGNS SHOWN ARE SCHEMATIC FOR THE FIELD WORK AND SOIL TESTS WERE CONDUCTED. THE DESIGNS ARE NOT INTENDED TO IMPOSE UNREALISTIC RESTRICTIONS ON THE LOT DEVELOPMENT OTHER THAN THOSE CONTAINED IN THE TOWN'S SUBDIVISION AND ZONING ORDINANCE REGULATIONS IN EFFECT WHEN THE PLANS WERE APPROVED.
- C. CERTIFICATIONS:  
 GREENE LAND SURVEYING, PLLC CERTIFIES THAT THE PLANS ARE BASED ON A TOPOGRAPHIC LOCATION SURVEY AND SOIL TESTS PERFORMED MARCH 9, 2020. THE PLANS CONFORM TO THE REQUIREMENTS OF THE TOWN ZONING ORDINANCE IN EFFECT THIS DATE. SIGNED:  
 MICHAEL C. SPONABLE, P.E. 081578 **DATE:** \_\_\_\_\_
- D. THE BUILDING LOCATION AND SETTINGS ARE SCHEMATIC FOR THE SITE BASED ON PRELIMINARY DISCUSSIONS WITH THE OWNER. THE DESIGN SHOWN WILL ALLOW SEWAGE PRODUCING FACILITIES IN THE BASEMENT WITHOUT PUMPING.

**PLAN OF LAND**  
 TO BE DEVELOPED BY  
**CARL A. & LISA K. NORSEN**

**TURNER ROAD**  
 IN  
 TOWN OF MACEDON  
 WAYNE COUNTY NEW YORK  
 MARCH 16, 2020 JOB No. 18-4419

GREENE LAND SURVEYING, PLLC 315-331-3999

© 2020 GREENE LAND SURVEYING, PLLC  
 ALL RIGHTS RESERVED. UNAUTHORIZED COPYING OR USE OF THESE PLANS IS PROHIBITED. A COPY OF THIS PLAN SHALL ONLY BE PRODUCE IN ORIGINAL FORM AND BE SIGNED, DATED AND HAVE THE ORIGINAL EMBOSSED OR COLORED (NOT BLUE STAMP) SURVEYOR'S SEAL.